

MAGNASOURCE INC.

CASTERS

**QUICK
REFERENCE
GUIDE**



Part #	Description	Qty. per	Part #	Description	Qty. per	
SY99-02187	SY37817	#620 wheel bearing	2	SYLCL2502	Grease axle	1
	SY107885	1/8 x 1 3/4 coiled spring pin	1	SYLCL2017	Grease fitting	1
	SYLCL2009	3/8 - 16 nut	3	SYLCL2003	O-ring	1
	SYLCL8008	3/8 - 16 x 4 nut bolt	1	SY99-02184	Spacer tube	2
	SYLCL2008	3/8 - 16 x 4 1/2 bolt	2	SY99-02026A	Sub assembly torsion block*	1
	SYLCL2503	3/4 - 10 nut lock	1	SYLCL2002	Thrust bearing	1
	SY99-02935	3/4 plow bolt dome head	1	SYLCL2001	Thrust washer	2
	SYF9433	92A poly wheel	1	SY40708	Timken bearing cone	1
	SY99-02181	Adjusting plate	2	SY99-02108	Wheel mounting plate	2
	SY99-02105	Base plate	1	SYLCL2026	Wheel spacer	1
	SYLCL2031	Dust seal	1			



Part #	Description	Qty. per	Part #	Description	Qty. per	
SY99-02188	SY37817	#620 wheel bearing	2	SYLCL2017	Grease fitting	1
	SY107885	1/8 x 1 3/4 coiled spring pin	1	SY99-02116-B	Mounting plate	1
	SYLCL2009	3/8 - 16 nut	2	SYLCL2003	O-ring	1
	SYLCL2008	3/8 - 16 x 4 1/2 bolt	2	SY99-02184	Spacer tube	1
	SYLCL2503	3/4 - 10 nut lock	1	SY99-02026A	Sub assembly torsion block*	1
	SY99-02935	3/4 plow bolt dome head	1	SYLCL2002	Thrust bearing	1
	SYF9433	92A poly wheel	1	SYLCL2001	Thrust washer	2
	SYLCL2026	Adjusting plate	2	SY40708	Timken bearing cone	1
	SYLCL2031	Dust seal	1	SY99-02110	Wheel mounting plate	2
	SYLCL2502	Grease axle	1	SYLCL2026	Wheel spacer	2



Part #	Description	Qty. per	Part #	Description	Qty. per	
SY99-02189	SYLCL2029	1/2 - 13 self locking nut hex	1	SY99-02104	Mounting plate	1
	SYLCL2006	1/2 - 13 x 4 1/2 hex head cap screw	1	SYLCL2003	O-ring	1
	SY107885	1/8 x 1 3/4 coiled spring pin	1	SYLCL2011	Spacer	1
	SY99-02935	3/4 plow bolt dome head	1	SY99-02184	Spacer tube	1
	SYLCL2009	3/8 - 16 nut	2	SY99-02026A	Sub assembly torsion block*	1
	SYLCL2008	3/8 - 16 x 4 1/2 bolt	2	SYLCL2002	Thrust bearing	1
	SYF9433	92A poly wheel	1	SYLCL2001	Thrust washer	2
	SYLCL2026	Adjusting plate	2	SY40708	Timken bearing cone	1
	SYLCL2010	Ball double seal bearing	2	SY99-02112	Wheel mounting plate	2
	SYLCL2031	Dust seal	1	SYLCL2026	Wheel spacer	2
	SYLCL2017	Grease fitting	1			



Part #	Description	
*SY99-02026A consists of	SY99-02026	Housing
	LP1425-3304-TIM	Timken bearing cup
	SY99-02025	Torsion block

	Part #	Description	Qty. per	Part #	Description	Qty. per
SY99-02190	SY37817	#620 wheel bearing	2	SYLCL2017	Grease fitting	1
	SY107885	1/8 x 1 3/4 coiled spring pin	1	SY99-02104	Mounting plate	1
	SYLCL2009	3/8 - 16 nut	2	SYLCL2003	O-ring	1
	SYLCL2008	3/8 - 16 x 4 1/2 bolt	2	SY99-02184	Spacer tube	1
	SYLCL2503	3/4 - 10 nut lock	1	SY99-02026A	Sub assembly torsion block*	1
	SY99-02935	3/4 plow bolt dome head	1	SYLCL2002	Thrust bearing	1
	SYF9433	92A poly wheel	1	SYLCL2001	Thrust washer	2
	SYLCL2026	Adjusting plate	2	SY40708	Timken bearing cone	1
	SYLCL2031	Dust seal	1	SY99-02108	Wheel mounting plate	2
	SYLCL2502	Grease axle	1	SYLCL2026	Wheel spacer	2



	Part #	Description	Qty. per	Part #	Description	Qty. per
SY99-02191	SY107885	1/8 x 1 3/4 coiled spring pin	1	SYLCL2003	O-ring	1
	SYLCL2009	3/8 - 16 nut	2	SY99-02114	Plate	2
	SYLCL2008	3/8 - 16 x 4 1/2 bolt	2	SYLCL2011	Spacer	1
	SY1222259	1/2 - 13 nut hex self locking	1	SY99-02184	Spacer tube	1
	SYLCL2006	1/2 - 13 x 4 1/2 hex head cap screw	2	SY99-02026A	Sub assembly torsion block*	1
	SY99-02935	3/4 plow bolt dome head	1	SYLCL2002	Thrust bearing	1
	SYF9433	92A poly wheel	1	SYLCL2001	Thrust washer	2
	SYLCL2010	Ball double seal bearing	2	SY40708	Timken bearing cone	1
	SY99-02105	Base plate	1	SY99-02108	Wheel mounting plate	2
	SYLCL2031	Dust seal	1	SYLCL2026	Wheel spacer	2
	SYLCL2017	Grease fitting	1			



	Part #	Description	Qty. per	Part #	Description	Qty. per
SY99-02192	SY37817	#620 wheel bearing	2	SYLCL2017	Grease fitting	1
	SY107885	1/8 x 1 3/4 coiled spring pin	1	SYLCL2003	O-ring	1
	SYLCL2009	3/8 - 16 nut	2	SY99-02114	Plate	2
	SYLCL2008	3/8 - 16 x 4 1/2 bolt	2	SY99-02184	Spacer tube	1
	SYLCL2503	3/4 - 10 nut lock	1	SY99-02026A	Sub assembly torsion block*	1
	SY99-02935	3/4 plow bolt dome head	1	SYLCL2002	Thrust bearing	1
	SYF9433	92A poly wheel	1	SYLCL2001	Thrust washer	2
	SY99-02105	Base plate	1	SY40708	Timken bearing cone	1
	SYLCL2031	Dust seal	1	SY99-02111	Wheel mounting plate	2
	SYLCL2502	Grease axle	1	SYLCL2026	Wheel spacer	2



	Part #	Description
*SY99-02026A consists of	SY99-02026	Housing
	LP1425-3304-TIM	Timken bearing cup
	SY99-02025	Torsion block

Part #	Description	Qty. per	Part #	Description	Qty. per	
SY99-02194	SY107885	1/8 x 1 3/4 coiled spring pin	1	SY99-02186	Mounting plate	1
	SYLCL2009	3/8 - 16 nut	1	SY99-02108	Mounting wheel plate	2
	SYLCL2008	3/8 - 16 x 4 1/2 bolt	1	SYLCL2003	O-ring	1
	SYLCL2029	1/2 - 13 self locking nut hex	1	SYLCL2011	Spacer	1
	SYLCL2006	1/2 - 13 x 4 1/2 hex head cap screw	1	SY99-02184	Spacer tube	1
	SY99-02935	3/4 plow bolt dome head	1	SY99-02026A	Sub assembly torsion block*	1
	SYF9433	92A poly wheel	1	SYLCL2002	Thrust bearing	1
	SYLCL2026	Adjusting plate	2	SYLCL2001	Thrust washer	2
	SYLCL2010	Ball double seal bearing	2	SY40708	Timken bearing cone	1
	SYLCL2031	Dust seal	1	SYLCL2026	Wheel spacer	2
	SYLCL2017	Grease fitting	1			



Part #	Description	Qty. per	Part #	Description	Qty. per	
SY99-02195	SY37817	#620 wheel bearing	2	SYLCL2017	Grease fitting	1
	SY107885	1/8 x 1 3/4 coiled spring pin	1	SY99-02116-B	Mounting plate	1
	SYLCL2009	3/8 - 16 nut	1	SY99-02108	Mounting wheel plate	2
	SYLCL2008	3/8 - 16 x 4 1/2 bolt	1	SYLCL2003	O-ring	1
	SYLCL2503	3/4 - 10 nut lock	1	SY99-02184	Spacer tube	1
	SY99-02935	3/4 plow bolt dome head	1	SY99-02026A	Sub assembly torsion block*	1
	SYF9433	92A poly wheel	1	SYLCL2002	Thrust bearing	2
	SYLCL2026	Adjusting plate	2	SYLCL2001	Thrust washer	1
	SYLCL2031	Dust seal	1	SY40708	Timken bearing cone	1
	SYLCL2502	Grease axle	1	SYLCL2026	Wheel spacer	2

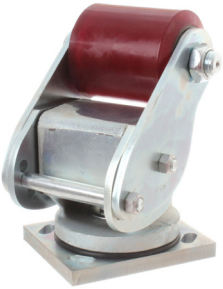

Part #	Description	Qty. per	Part #	Description	Qty. per	
SY99-02196	SY107885	1/8 x 1 3/4 coiled spring pin	1	SY99-02116-B	Mounting plate	1
	SYLCL2009	3/8 - 16 nut	1	SY99-02185	Mounting wheel plate	2
	SY1222262	3/8 - 16 x 4 bolt	2	SYLCL2003	O-ring	1
	SYLCL2029	1/2 - 13 self locking nut hex	1	SYLCL2011	Spacer	1
	SYLCL2006	1/2 - 13 x 4 1/2 hex head cap screw	1	SY99-02184	Spacer tube	1
	SY99-02935	3/4 plow bolt dome head	1	SY99-02026A	Sub assembly torsion block*	1
	SYF9433	92A poly wheel	1	SYLCL2002	Thrust bearing	1
	SYLCL2026	Adjusting plate	2	SYLCL2001	Thrust washer	2
	SYLCL2010	Ball double seal bearing	2	SY40708	Timken bearing cone	1
	SYLCL2031	Dust seal	1	SYLCL2026	Wheel spacer	2
	SYLCL2017	Grease fitting	1			



Part #	Description	
*SY99-02026A consists of	SY99-02026	Housing
	LP1425-3304-TIM	Timken bearing cup
	SY99-02025	Torsion block

	Part #	Description	Qty. per	Part #	Description	Qty. per
SY99-02197	SY37817	#620 wheel bearing	2	SYLCL2017	Grease fitting	1
	SY107885	1/8 x 1 3/4 coiled spring pin	1	SY99-02116-B	Mounting plate	1
	SYLCL2009	3/8 - 16 nut	2	SY99-02108	Mounting wheel plate	2
	SY1222262	3/8 - 16 x 4 bolt	2	SYLCL2003	O-ring	1
	SYLCL2503	3/4 - 10 nut lock	1	SY99-02184	Spacer tube	1
	SY99-02935	3/4 plow bolt dome head	1	SY99-02026A	Sub assembly torsion block*	1
	SYF9433	92A poly wheel	1	SYLCL2002	Thrust bearing	2
	SYLCL2026	Adjusting plate	2	SYLCL2001	Thrust washer	2
	SYLCL2031	Dust seal	1	SY40708	Timken bearing cone	1
	SYLCL2502	Grease axle	1	SYLCL2026	Wheel spacer	2



	Part #	Description	Qty. per	Part #	Description	Qty. per
SY99-02198	SY107885	1/8 x 1 3/4 coiled spring pin	1	SY99-02103	Mounting plate	1
	SYLCL2009	3/8 - 16 nut	3	SY99-02185	Mounting wheel plate	2
	SYLCL2008	3/8 - 16 x 4 1/2 bolt	2	SYLCL2003	O-ring	1
	SYLCL2029	1/2 - 13 self locking nut hex	1	SYLCL2011	Spacer	1
	SYLCL2006	1/2 - 13 x 4 1/2 hex head cap screw	1	SY99-02184	Spacer tube	1
	SY99-02935	3/4 plow bolt dome head	1	SY99-02026A	Sub assembly torsion block*	1
	SYF9433	92A poly wheel	1	SYLCL2002	Thrust bearing	1
	SYLCL2026	Adjusting plate	2	SYLCL2001	Thrust washer	2
	SYLCL2010	Ball double seal bearing	1	SY40708	Timken bearing cone	1
	SYLCL2031	Dust seal	1	SYLCL2026	Wheel spacer	2
	SYLCL2017	Grease fitting	1			



	Part #	Description	Qty. per	Part #	Description	Qty. per
SY99-02199	SY37817	#620 wheel bearing	2	SYLCL2017	Grease fitting	1
	SY107885	1/8 x 1 3/4 coiled spring pin	1	SY99-02103	Mounting plate	1
	SYLCL2009	3/8 - 16 nut	2	SY99-02108	Mounting wheel plate	2
	SYLCL2008	3/8 - 16 x 4 1/2 bolt	2	SYLCL2003	O-ring	1
	SYLCL2503	3/4 - 10 nut lock	1	SY99-02184	Spacer tube	1
	SY99-02935	3/4 plow bolt dome head	1	SY99-02026A	Sub assembly torsion block*	1
	SYF9433	92A poly wheel	2	SYLCL2002	Thrust bearing	2
	SYLCL2026	Adjusting plate	2	SYLCL2001	Thrust washer	1
	SYLCL2031	Dust seal	1	SY40708	Timken bearing cone	1
	SYLCL2502	Grease axle	1	SYLCL2026	Wheel spacer	2



	Part #	Description
*SY99-02026A consists of	SY99-02026	Housing
	LP1425-3304-TIM	Timken bearing cup
	SY99-02025	Torsion block

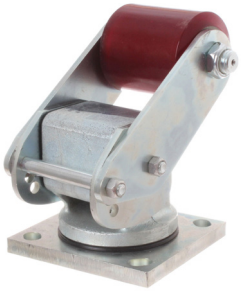





	Part #	Description	Qty. per	Part #	Description	Qty. per	
	SY99-02200	SY37817	#620 wheel bearing	2	SYLCL2017	Grease fitting	1
		SY107885	1/8 x 1 3/4 coiled spring pin	1	SY99-02116-B	Mounting plate	1
		SYLCL2009	3/8 - 16 nut	2	SY99-02108	Mounting wheel plate	2
		SY1222262	3/8 - 16 x 4 bolt	2	SYLCL2003	O-ring	1
		SYLCL2503	3/4 - 10 nut lock	1	SY99-02184	Spacer tube	1
		SY99-02935	3/4 plow bolt dome head	1	SY99-02026A	Sub assembly torsion block*	1
		SYF9433	92A poly wheel	1	SYLCL2002	Thrust bearing	2
		SYLCL2026	Adjusting plate	2	SYLCL2001	Thrust washer	2
		SYLCL2031	Dust seal	1	SY40708	Timken bearing cone	1
		SYLCL2502	Grease axle	1	SYLCL2026	Wheel spacer	2

	Part #	Description
*SY99-02026A consists of	SY99-02026	Housing
	LP1425-3304-TIM	Timken bearing cup
	SY99-02025	Torsion block

KEY

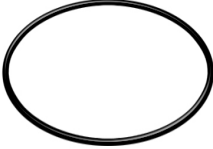
Part #	Description	Part #	Description	Part #	Description
SY37817	#620 wheel bearing	SYLCL2008	3/8 - 16 x 4 1/2 bolt	SYF9433	92A poly wheel
					
SY107885	1/8 x 1 3/4 coiled spring pin	SYLCL2029	1/2 - 13 self locking nut hex	SYLCL2026	Adjusting plate
					
SYLCL2009	3/8 - 16 nut	SYLCL2006	1/2 - 13 x 4 1/2 hex head cap screw	SY99-02181	Adjusting plate
					
SY1222262	3/8 - 16 x 4 bolt	SYLCL2503	3/4 - 10 nut lock	SYLCL2010	Ball double seal bearing
					
SYLCL8008	3/8 - 16 x 4 nut bolt	SY99-02935	3/4 plow bolt dome head	SY99-02105	Base plate
					

Part #	Description
SYLCL2031	Dust seal
	
SYLCL2502	Grease axle
	
SYLCL2017	Grease fitting
	
SY99-02026	Housing
	
SY99-02116-B	Mounting plate
	
SY99-02186	Mounting plate
	
SY99-02108	Mounting wheel plate
	
SY99-02111	Mounting wheel plate
	

Part #	Description
SY99-02112	Mounting wheel plate
	
SY99-02185	Mounting wheel plate
	
SYLCL2003	O-ring
	
SY99-02114	Plate
	
SYLCL2011	Spacer
	
SY99-02184	Spacer tube
	

Part #	Description
SYLCL2002	Thrust bearing
	
SYLCL2001	Thrust washer
	
SY40708	Timken bearing cone
	
LP1425-3304-TIM	Timken bearing cup
	
SY99-02025	Torsion block
	
SYLCL2026	Wheel spacer
	



Parts sourced by TVH.

MAGNASOURCE INC.

833-362-8590 / support@magnasourceinc.com
WWW.MAGNASOURCEINC.COM